

# Peugeot Bipper - Hard or no start engine

**Question:** We are having difficulty diagnosing a fault on a 2011 Peugeot Bipper 1.3 litre Diesel. The engine is difficult to start, and intermittently does not start at all. We have checked fuel and air supplies, and they are OK. We have also checked for any stored trouble codes, none were present. Can you assist us?

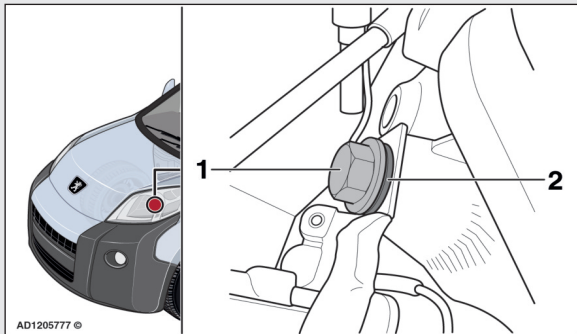

**The engine earth lead bolt (1) and washer (2)**

**Answer:** There is a known fault to check for on the Bipper models with F13DTE5 (FHZ) engine code, from 11/03/11 (RPO12541). The probable cause of the fault is a poor connection between the engine earth lead and the transmission housing. Remove the engine earth lead bolt from transmission housing Fig.1.1. Thoroughly clean all mating surfaces. Fit washer to the

engine earth lead bolt Fig.1.2. Refit the engine earth lead bolt Fig.1.1. Tighten the engine earth lead bolt to correct torque setting. This should rectify the fault.