



To Fit:

Mercedes-Benz with 5-gear auto gearbox 722.6



Need to check the oil level in a Mercedes-Benz 5-gear autogearboxes (722.6)? No problem! febi has the solution! Dipstick for auto gearboxes

The oil level in an auto gearbox should be checked after an oil change or if there is a suspected leak. No dipstick is provided for the gearbox at the factory.

The filler tube is located in the engine compartment (Fig. 1). The locking cap of the filler tube has a safety device to secure it against accidental opening. The disk of the locking pin has to be broken off using an appropriate tool before measuring the oil level (Fig. 2); remove the locking pin and remove the locking cap (Fig. 3).

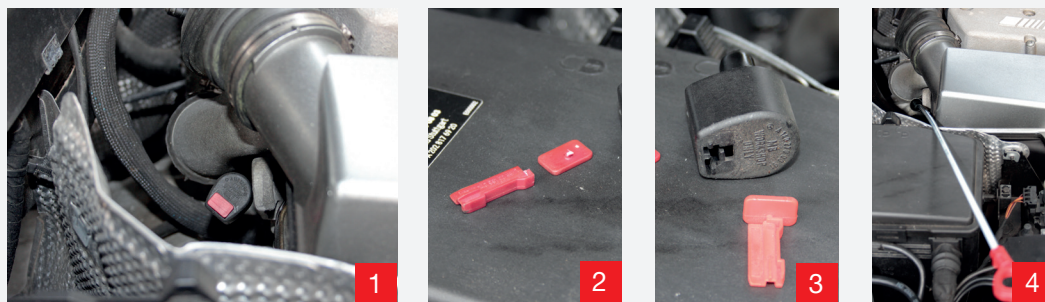

For more technical information please visit: partsfinder.bilsteingroup.com



febi 44204

EN

Be sure to remove the dipstick after measuring the oil level! The locking cap can be secured again with a new locking pin (febi 44204).

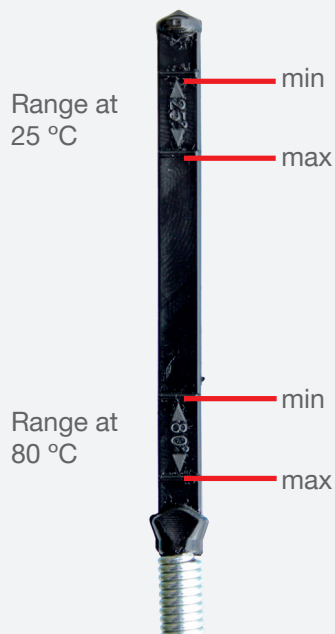

Attention!

When checking the oil level, insert the dipstick into the filler tube as far as it will go. The filler tube differs in length as the gearbox referred to above is used in various models. Part of the dipstick may protrude from the tube once the dipstick has reached the bottom of the gearbox (Fig. 4).

For more technical information please visit: partsfinder.bilsteingroup.com